

Installation Video

An installation video is available here:
<http://www.uuberstore.com/stcg5-install>

G5 Standard Installation

1. Stretch the outer rubber skin and separate it from the inner hard case.
2. Start with the charging port, separate the inner hard case by splitting it into a front frame and a back tray.
3. Place the iPad in the back tray. Line up the iPad's back camera with the corresponding camera opening on the back tray.
4. Place the front frame over the iPad. Line up the front camera and button holes with the iPad.
5. Close the inner hard case by squeezing the corners and sides together. You may find that working on opposite corners followed by opposite sides work better than going around the case in one direction. You will hear a series of snaps when the case is closed properly.
6. Replace the outer rubber skin over the hard case.

Removal

1. Reverse the installation steps to remove the case.
2. There are four coin slots along the edge of the inner hard shell that can be used to open it. Start with the charging port and use a coin to pry the case open.
3. If you need to remove a large quantity of cases, a flat-head screwdriver can be used to make the task easier.

Cleaning and Caring

1. The best way to clean the iPad case is by using a dry, soft cloth.
2. The Slim Tough Case can be cleaned with all popular household cleaners. When in doubt, test a small amount of cleaning agent in an inconspicuous area.

Slim Tough Case G5 for iPad Air 2

G5 Folio Installation

Removing the front folio cover

Press on the locking tab on the left edge. Slide the hard cover assembly upwards to separate it from the main case.

Installing the front folio cover

1. Identify the metal pins and match up to the hinge
2. Insert the bottom pin into the hinge hole
3. Depress the locking tab with the top part of the folio cover, line up the top pin with hinge hole
4. Slide the folio cover downward until the locking tab pops out, locking the folio cover in place

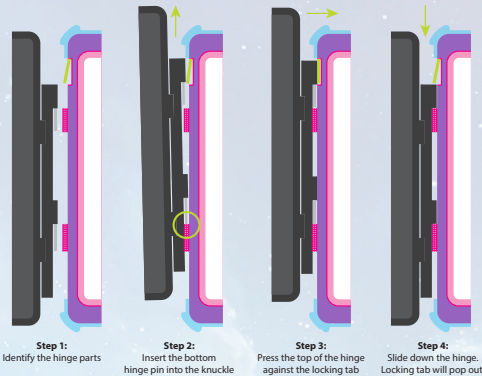

Kickstand

1. The front hard cover can be folded to the back to set up the iPad at a low-rise typing angle, or a presentation angle.
2. The small kickstand on the back can be used when the hard cover is not attached.

üuber
 CUSTOM ELECTRONIC ACCESSORIES

Sunrise Hitek Group, LLC.

5915 N. Northwest Hwy., Chicago, IL 60631
<https://www.uuberstore.com>